



YONGE STREET &
CUMBERLAND STREET
TORONTO, ON

8 Cumberland TORONTO

FIRST GULF

8 Cumberland

Retail

Up to 4,500 sf of retail space with potential for mezzanine in an urban, luxury condo.

- Located on Cumberland just west of Yonge.
- 51-storeys of residential adding approx. 370 condo units to Yorkville.
- 4,500 sf of ground-floor retail space.
- Conveniently located a short walk away from Bloor-Yonge and Bay subway stations, providing access to both the Yonge-University and Bloor-Danforth subway lines.
- A short walk to great shopping, dining and entertainment options.



NEIGHBOURHOOD DEMOGRAPHICS



32,872 VEHICLES PER DAY
Average Daily Traffic Count along Yonge St.



TRADE AREA POPULATION**
within 1 km - 67,589
within 5 km - 826,991
within 10 km - 1,606,465



10 YEAR PROJECTED POP GROWTH**
within 1 km - 31%
within 5 km - 20%
within 10 km - 16%



AVERAGE HOUSEHOLD INCOME**
within 1 km - \$179,910
within 5 km - \$157,366
within 10 km - \$158,107



TRADE AREA HOUSEHOLDS**
within 1 km - 38,601
within 5 km - 411,633
within 10 km - 721,543

** ESRI Business Analyst, 2025



Site Plan



- AVAILABLE
- LEASED

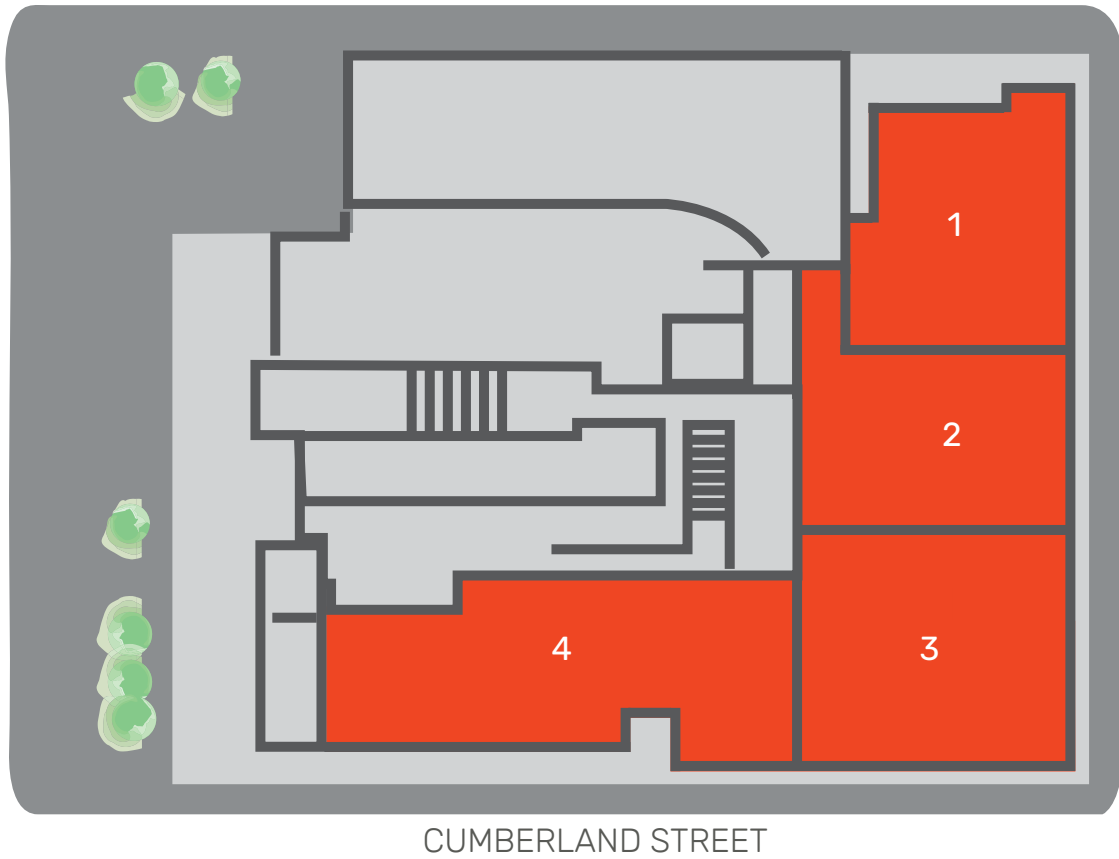

AVAILABILITIES

UNIT	TENANT	AREA (SF)
1	Available	1,063
2	Available	865
3	Available	1,199
4	Available	1,361
TOTAL:		4,512



WALK SCORE
100



TRANSIT SCORE
97



BIKE SCORE
66



FOR MORE INFORMATION, PLEASE CONTACT

Jonathan Weinberg
416.773.7067
jweinberg@firstgulf.com

Michael O'Connor
416.773.7071
moconnor@firstgulf.com

FIRST GULF

351 King Street East
Toronto, ON
T: 416.491.7778
F: 416.491.1351

firstgulf.com